

NRSE Series

SMD Shielded Tiny Power Inductor

Size 8040

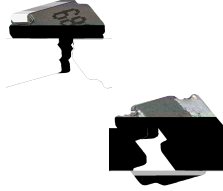

CHARACTERISTICS

-
-

APPLICATION

-
-

Dimensions: [mm]

Land Pattern: [mm]

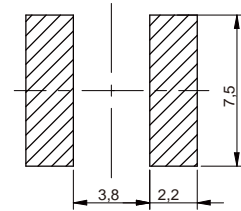
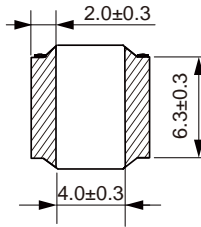
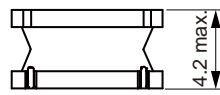
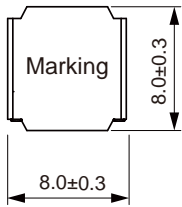

Electrical Properties:

Part No	(μH)	Tolerance	Saturation (A)	Temperature Rise (A)	($\text{m}\Omega$)	Condition
					5	
					8	
				5.65		
	2.2					
	3.3					
	4.7					
	5.6				24	
	6.8		4.55		28	
	8.2				35	
					37	
					45	
					56	
					58	
	22				74	
	27					
	33					
	47					
	56					

Part No	(μH)	Tolerance	Saturation (A)	Temperature Rise (A)	($\text{m}\Omega$)	Condition
	68					
	82				245	
					538	

° °

°

Typical Electrical Characteristics:

Inductance VS. Current Characteristics:

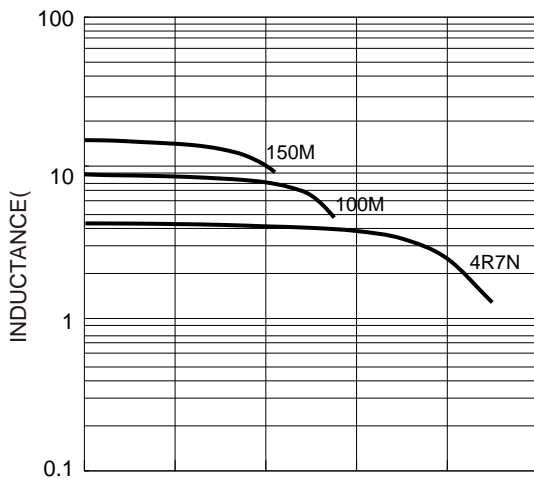

Temperature Rise VS. Current Characteristics:

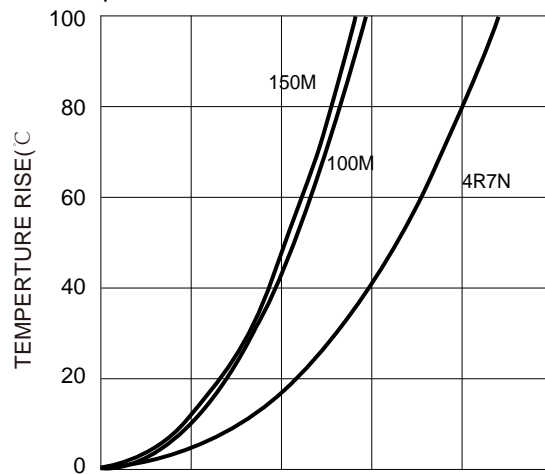

Soldering Reflow:

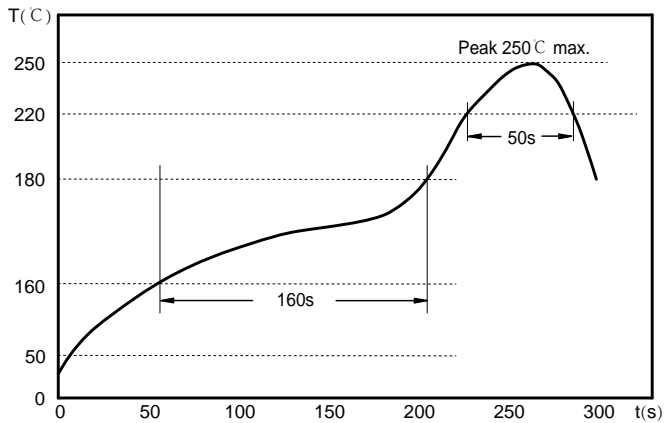

Preheat condition: 160 ~180°C / 160 sec.

Allowed time above 220°C : 50 sec.

Max temperature: 250°C.

Packaging Information:

Tape Dimension :

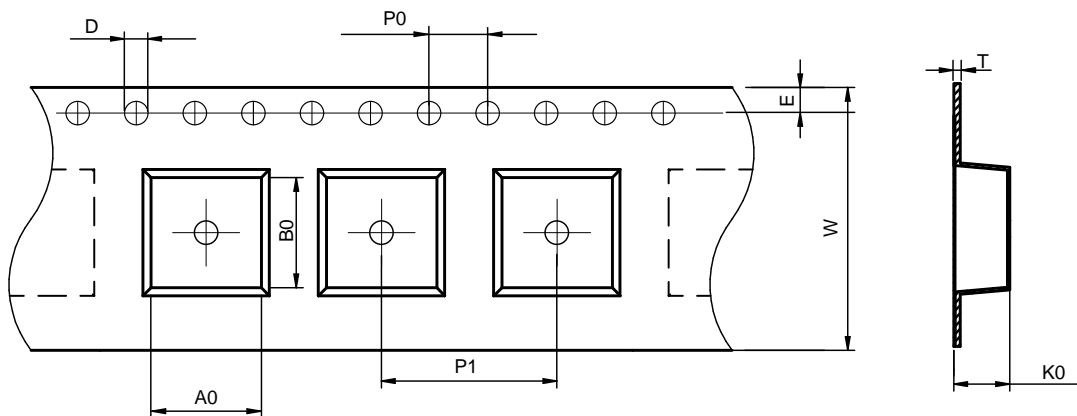

Series	A0	B0	D	P0	P1	W	K0	E	T
NRSE8040	9.40±0.1	9.40±0.1	1.50±0.1	4.00±0.1	12.00±0.1	16.00±0.3	4.40±0.1	1.75±0.1	0.40±0.05

Peel force of top cover tape:

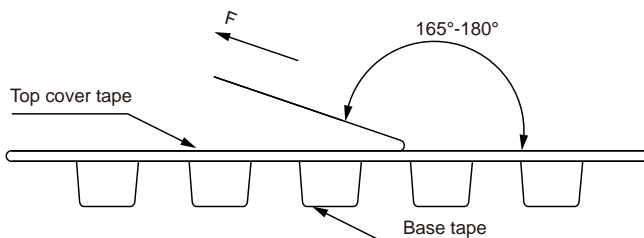

The peel force of top cover tape shall be between 0.03 to 0.98 N

Product Marking:

Marking	Printing (Inductance)
---------	-----------------------

Reel Dimension: [mm]

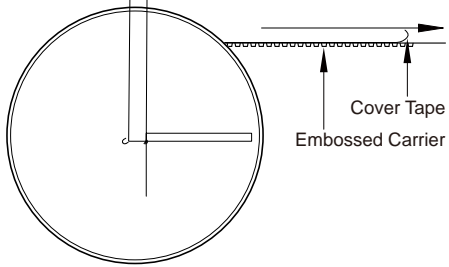

Packaging Quantity: