

# NRSE Series

## SMD Shielded Tiny Power Inductor

### Size 6045

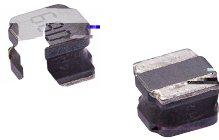

#### FEATURES

- Magnetic resin for higher current and semi-magnetically shielded
- Operating temperature: -40 °C to +125 °C
- Quantity: 1500pcs

#### APPLICATION

- DC/DC converter
- LC filter

#### Dimensions: [mm]

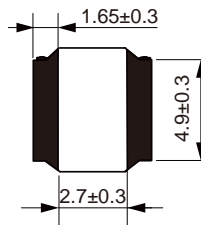
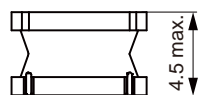
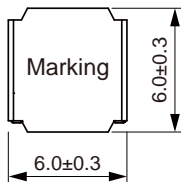

#### Land Pattern: [mm]

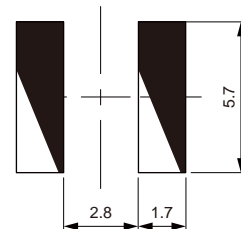

#### Electrical Properties:

	( $\mu\text{H}$ )		Saturation		( $\text{m}\Omega$ )	Condition
NRSE6045-R56N	0.56	±30%	14.5	6.20	7.50	1MHz/0.25V
NRSE6045-1R0N	1.00	±30%	9.00	5.10	10.0	100KHz/0.25V
NRSE6045-1R5N	1.50	±30%	7.50	4.75	12.0	100KHz/0.25V
NRSE6045-1R8N	1.80	±30%	7.50	4.60	13.0	100KHz/0.25V
NRSE6045-2R2N	2.20	±30%	6.50	4.60	13.0	100KHz/0.25V
NRSE6045-3R3N	3.30	±30%	5.30	3.20	20.0	100KHz/0.25V
NRSE6045-3R9N	3.90	±30%	4.90	3.20	20.0	100KHz/0.25V
NRSE6045-4R7N	4.70	±30%	4.50	3.00	24.0	100KHz/0.25V
NRSE6045-5R6N	5.60	±30%	3.70	2.80	31.0	100KHz/0.25V
NRSE6045-6R8M	6.80	±20%	3.30	2.70	33.0	100KHz/0.25V
NRSE6045-8R2M	8.20	±20%	3.20	2.60	45.0	100KHz/0.25V
NRSE6045-100M	10.0	±20%	3.00	2.50	52.0	100KHz/0.25V
NRSE6045-120M	12.0	±20%	2.80	2.20	58.0	100KHz/0.25V
NRSE6045-150M	15.0	±20%	2.50	1.90	77.0	100KHz/0.25V
NRSE6045-180M	18.0	±20%	2.20	1.75	95.0	100KHz/0.25V
NRSE6045-220M	22.0	±20%	2.00	1.50	115	100KHz/0.25V

	( $\mu\text{H}$ )		Saturation		( $\text{m}\Omega$ )	Condition
NRSE6045-270M	27.0	$\pm 20\%$	1.90	1.48	120	100KHz/0.25V
NRSE6045-330M	33.0	$\pm 20\%$	1.60	1.45	150	100KHz/0.25V
NRSE6045-390M	39.0	$\pm 20\%$	1.50	1.25	180	100KHz/0.25V
NRSE6045-470M	47.0	$\pm 20\%$	1.40	1.20	220	100KHz/0.25V
NRSE6045-560M	56.0	$\pm 20\%$	1.30	1.10	260	100KHz/0.25V
NRSE6045-680M	68.0	$\pm 20\%$	1.20	0.90	290	100KHz/0.25V
NRSE6045-820M	82.0	$\pm 20\%$	1.10	0.85	355	100KHz/0.25V
NRSE6045-101M	100	$\pm 20\%$	1.00	0.80	430	100KHz/0.25V
NRSE6045-121M	120	$\pm 20\%$	0.85	0.75	530	100KHz/0.25V
NRSE6045-151M	150	$\pm 20\%$	0.80	0.70	760	100KHz/0.25V
NRSE6045-181M	180	$\pm 20\%$	0.75	0.65	845	100KHz/0.25V
NRSE6045-221M	220	$\pm 20\%$	0.63	0.55	890	100KHz/0.25V
NRSE6045-331M	330	$\pm 20\%$	0.57	0.50	1851	100KHz/1V

Saturation Current will cause L to drop approximately 30%

Temperature Rise Current: The actual value of DC current when the temperature rise is  $\Delta T=40^\circ\text{C}$

### Typical Electrical Characteristics:

Inductance VS. Current Characteristics:

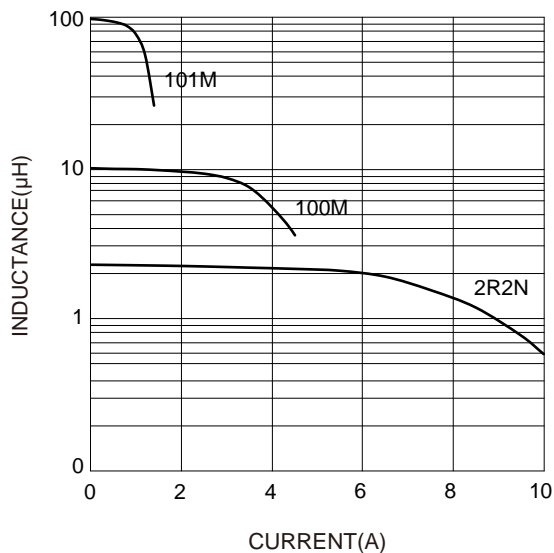

Temperature Rise VS. Current Characteristics:

