

# MDE Series

## Molding Power Inductors

### Size 0530



#### FEATURES

- 
- 
- $^{\circ}\text{C}$  maximum total temperature operation
- 
- Ultra low buzz noise due to molding construction
- 
- Operating temperature range - 55  $^{\circ}\text{C}$  to + 125  $^{\circ}\text{C}$
- Quantity: 2000pcs

#### APPLICATION

- Laptops and PCs
- 
- Base stations
- DC/DC converters
- Battery powered devices
- 

#### Dimensions: [mm]

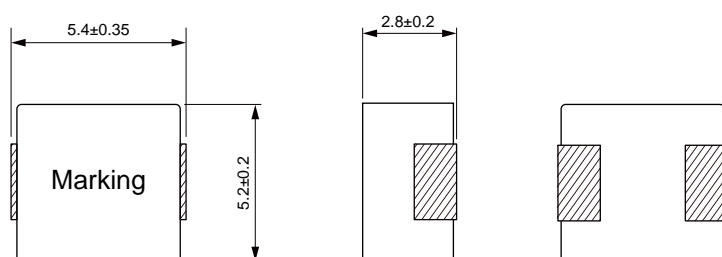

#### Land Pattern: [mm]

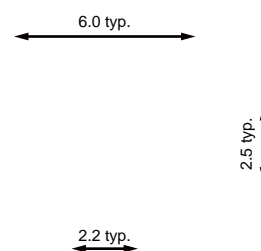

#### Electrical Properties:

Part No	Inductance @ 100kHz/1V	Tolerance	DC Resistance Max.	Current Typ. (A)	Temperature Rise Current Typ. (A)
MDE0530-R10M	0.10	±20%	3.00	30.0	25.0
MDE0530-R20M	0.20	±20%	3.90	20.0	14.0
MDE0530-R33M	0.33	±20%	5.50	18.0	14.0
MDE0530-R47M	0.47	±20%	8.50	15.0	11.0
MDE0530-R68M	0.68	±20%	12.0	11.5	9.00
MDE0530-1R0M	1.00	±20%	14.0	10.0	8.50
MDE0530-1R2M	1.20	±20%	16.0	9.50	8.50
MDE0530-1R5M	1.50	±20%	25.0	9.00	8.20
MDE0530-2R2M	2.20	±20%	29.0	7.00	7.00
MDE0530-3R3M	3.30	±20%	38.0	6.00	5.50
MDE0530-4R7M	4.70	±20%	60.0	4.60	4.50
MDE0530-6R8M	6.80	±20%	90.0	3.60	3.50
MDE0530-100M	10.0	±20%		3.50	3.20
MDE0530-220M	22.0	±20%		2.30	1.70

Saturation Current will cause L to drop approximately 30%

Temperature Rise Current: The actual value of DC current when the temperature rise is  $\Delta T=40^{\circ}\text{C}$

# Typical Electrical Characteristics:

