

**MDA Series**  
**SMD Low Profile High Current Molded Inductor**  
**Size 2313**

**FEATURES**

- 
- 
- 
- 
- 
- 
- 
- 
- 

Dimensions: [mm]

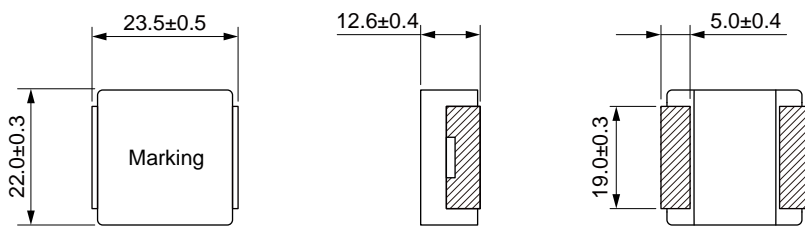

Land Pattern: [mm]

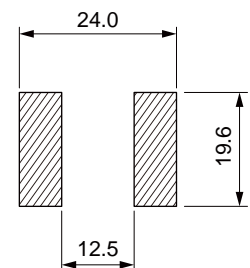

**Electrical Properties:**

	( $\mu\text{H}$ )			Saturation	( $\text{m}\Omega$ )	( $\text{m}\Omega$ )

	( $\mu\text{H}$ )			Saturation		( $\text{m}\Omega$ )	( $\text{m}\Omega$ )

Saturation Current will cause L to drop approximately 30%

Temperature Rise Current: The actual value of DC current when the temperature rise is  $\Delta T=40^\circ\text{C}$

### Typical Electrical Characteristics:

