

Molded Inductor Size 7078

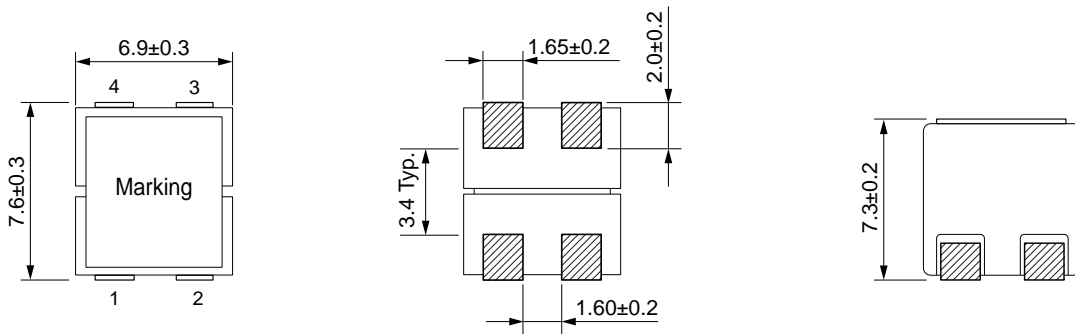

Dimensions: [mm]



Schematic:

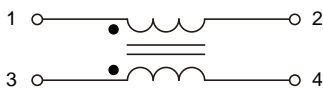

Land Pattern: [mm]

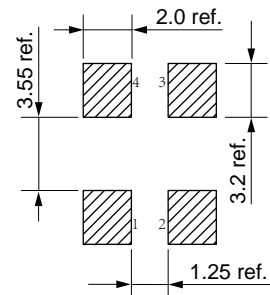

Electrical Properties:

	(μH)				Saturation	Saturation	($\text{m}\Omega$)

Saturation Current will cause L to drop approximately 30%

Temperature Rise Current: The actual value of DC current when the temperature rise is $\Delta T=40^{\circ}\text{C}$

Soldering Reflow:

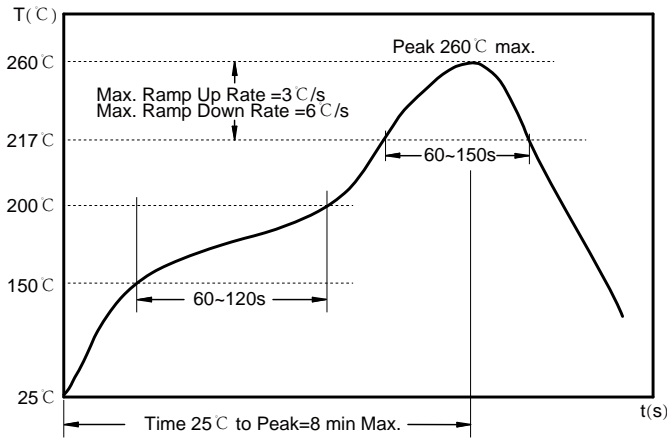

Preheat condition: 150 ~200°C / 60~120 sec.

Allowed time above 217°C: 60~150 sec.

Max temperature: 260°C.

Allowed Reflow time: 2x max.

Packaging Information:

Tape Dimension:

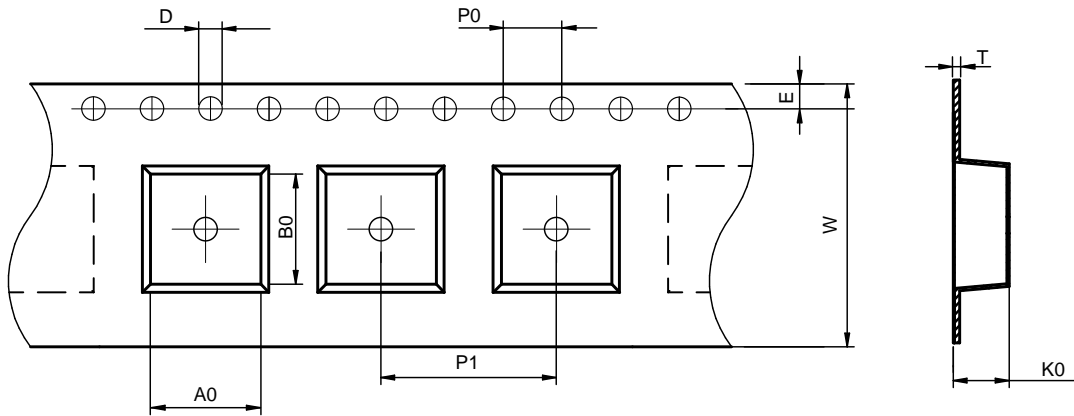

Series	A0 (mm)	B0 (mm)	D (mm)	P0 (mm)	P1 (mm)	W (mm)	K0 (mm)	E (mm)	T (mm)
DMMA7078	9.0±0.1	8.3±0.1	1.50±0.1	4.0±0.1	12.0±0.1	16.0±0.3	7.8±0.1	1.75±0.1	0.5 typ

Peel force of top cover tape:

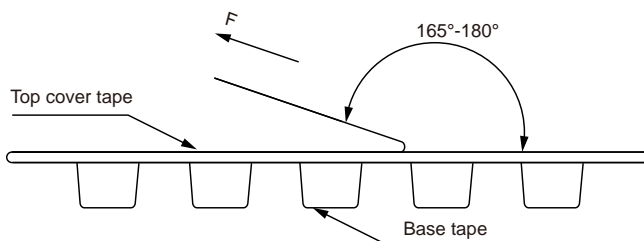

The peel force of top cover tape shall be between 0.1 to 1.3 N

Product Marking:

Marking	Printing (Inductance+period)

Reel Dimension: [mm]



Packaging Quantity: